

IGBT Modules / SKiM 4/5

1

Type	IGBT						Diode				Module	Circuit
	$I_c @ T_s = 25^\circ\text{C}$ A	I_{cnom} A	$V_{CE(sat)} @ T_j = 25^\circ\text{C typ.}$ V	E_{on} mJ	E_{off} mJ	$R_{th(j-s)}$ K/W	$I_F @ T_s = 25^\circ\text{C}$ A	$V_F @ T_j = 25^\circ\text{C typ.}$ V	E_{rr} mJ	$R_{th(j-s)}$ K/W		
600V - IGBT3 (Trench)												
SKiM301MLI07E4	248	300	1.55	2.78	17.48	0.3	177	1.40	-	0.53	4	
SKiM401MLI07E4	319	400	1.55	3.32	20.91	0.25	289	1.40	1.8	0.31	4	
SKiM601MLI07E4	440	600	1.55	6.05	44	0.19	318	1.39	2.4	0.31	4	
1200V - IGBT3 (Trench)												
SKiM200GD126D	-	200	1.65	15	25	-	152	2.4	-	0.35	4	
SKiM300GD126D	265	300	1.70	28	47	0.2	260	1.9	-	0.285	4	
SKiM300GD126DL	265	300	1.65	28	47	0.2	260	1.9	-	0.285	4	
SKiM400GD126DM	330	300	1.70	29	46	0.134	300	1.9	-	0.19	4	
SKiM400GD126DLM	330	300	1.65	29	46	0.134	300	1.9	-	0.19	4	
SKiM450GD126D	390	450	1.70	42	70	0.13	345	1.9	-	0.19	5	
SKiM450GD126DL	390	450	1.65	42	70	0.13	345	1.9	-	0.19	5	
SKiM600GD126DLM	480	450	1.65	42	70	0.09	450	1.9	-	0.125	5	
SKiM601GD126DM	480	450	1.70	42	70	0.09	450	1.9	-	0.125	5	
1200V - IGBT4 (Trench)												
SKiM304GD12T4D	312	300	1.80	-	-	0.19	221	2.3	-	0.25	4	
SKiM455GD12T4D1	400	450	1.80	34	40	0.14	295	2.3	28	0.19	5	
SKiM201MLI12E4	206	200	1.80	14.81	22.6	0.29	187	2.20	14.78	0.36	4	
SKiM301MLI12E4	311	300	1.80	22.2	33.9	0.19	282	2.20	21.8	0.24	4	
SKiM301TMLI12E4B	311	300	1.80	6.62	19.37	0.19	249	2.20	1.79	0.29	4	
SKiM301TMLI12E4C	294	300	1.80	6.619	19.376	0.21	274	2.20	1.79	0.25	4	
SKiM401TMLI12E4B	411	400	1.80	8.83	25.83	0.145	365	2.20	2.391	0.188	4	
SKiM601TMLI12E4B	529	600	1.80	11.44	44.88	0.125	495	2.14	4.37	0.15	4	
1700V - IGBT3 (Trench)												
SKiM120GD176D	110	125	2	72	46	0.4	105	1.6	22	0.56	4	
SKiM220GD176DH4	220	250	2	145	100	0.21	220	1.7	65	0.26	4	

IGBT Modules / SKiM 4/5

Type	IGBT					Diode					Module	
	$I_C @ T_s = 25^\circ\text{C}$	I_{Cnom}	$V_{CE(sat)} @ T_j = 25^\circ\text{C typ.}$	E_{on}	E_{off}	$R_{th(j-s)}$	$I_F @ T_s = 25^\circ\text{C}$	$V_F @ T_j = 25^\circ\text{C typ.}$	E_{rr}	$R_{th(j-s)}$	Case	
	A	A	V	mJ	mJ	K/W	A	V	mJ	K/W		Circuit
1700V - IGBT3 (Trench)												
SKiM270GD176D	260	300	2.00	170	120	0.175	215	1.7	-	0.29	5	

Cases

SKiM 4

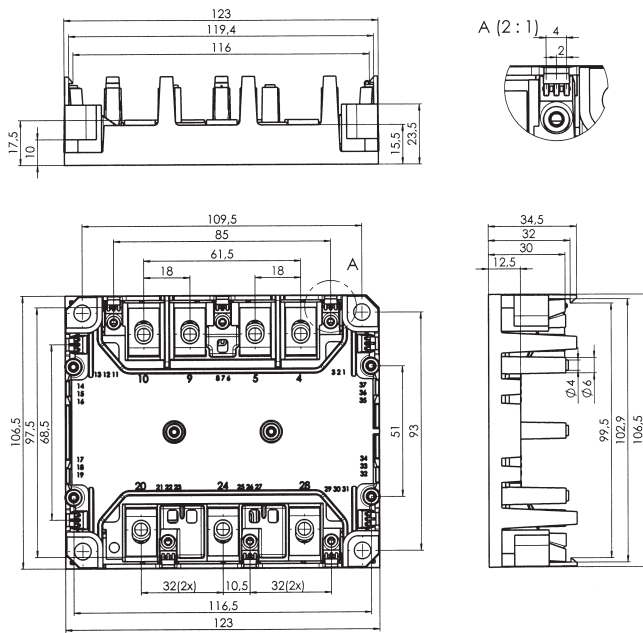

SKiM 5

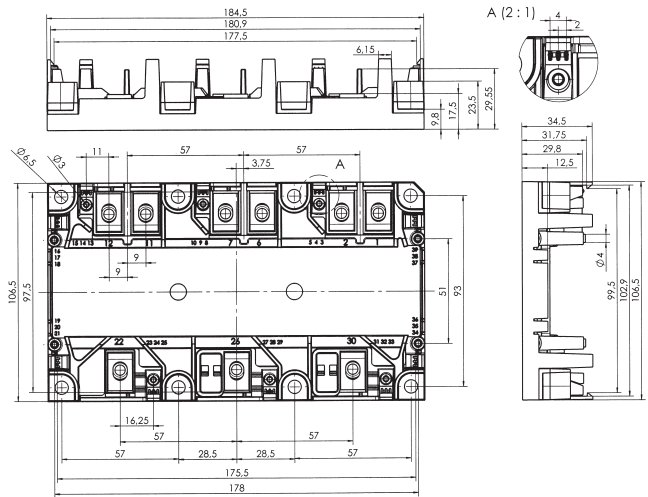

Dimensions in mm