

DRG.No.B 020300

POWERSEM LTD.

FIXINGS M6 CLEAR
 AC CONNECTIONS M8 / M10 CLEAR
 DC CONNECTIONS VIA M8 NUT CHANNELS

CIRCUIT	DC1	DC2
B6-U/HA/C	+VE	-VE
B6-HK	-VE	+VE

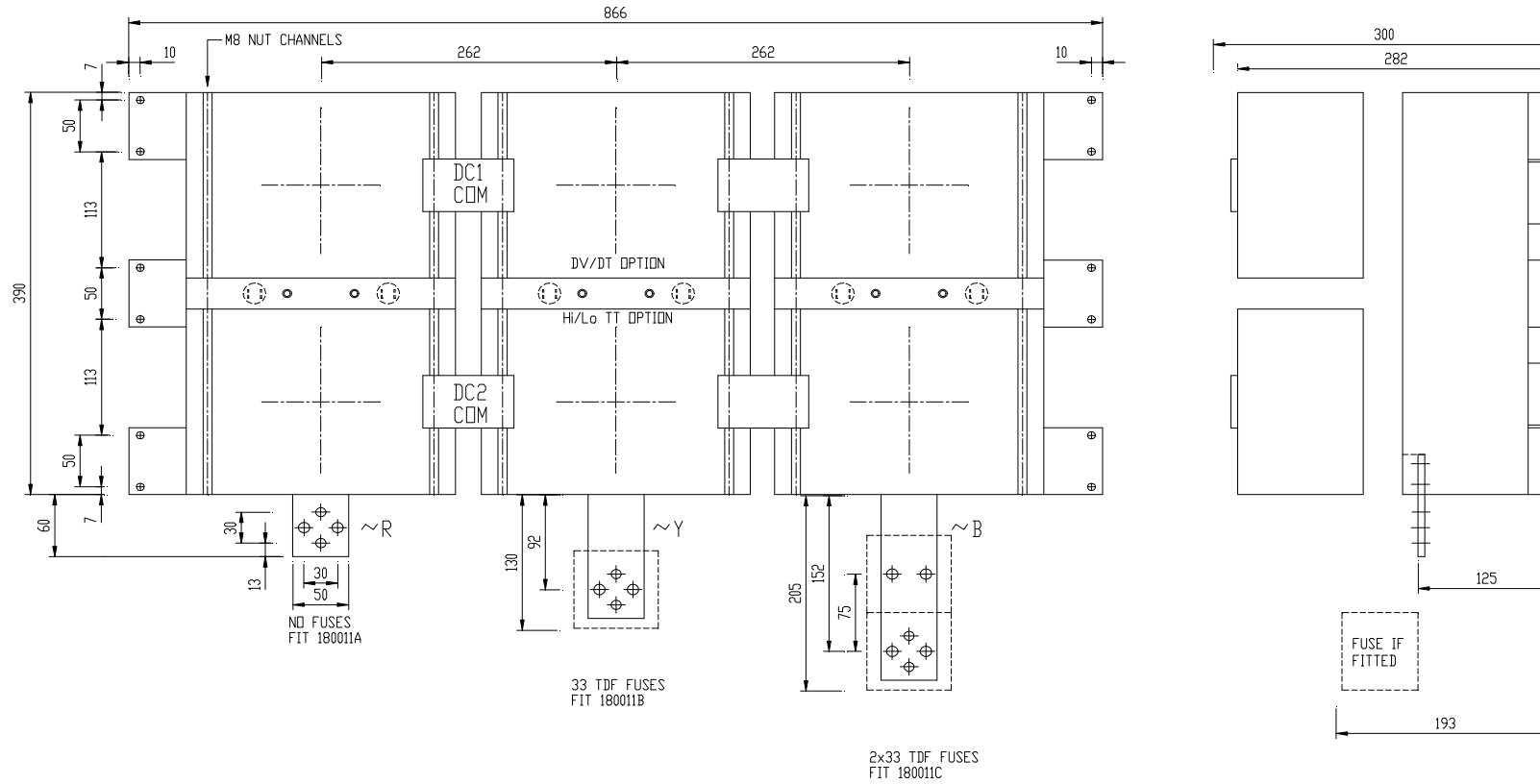

TOLERANCES UNLESS SPECIFIED
 UNLIMITED DIMENSIONS TO BE ± 0.2
 ANGLES ± 0° 30'
 HOLES + 0.1 - 0.02

REMOVE SHARP EDGES
 ALL DIMENSIONS IN MILLIMETRES
 CHAMFER ALL THREADS AT 45 TO
 ROOT DIAMETER.

POWERSEM LTD OWNS THE COPYRIGHT OF THIS DRAWING WHICH IS
 SUPPLIED IN CONFIDENCE AND WHICH MUST NOT BE USED FOR ANY PURPOSE OTHER THAN
 THAT FOR WHICH IT IS SUPPLIED, AND MUST NOT BE REPRODUCED WITHOUT PERMISSION
 IN WRITING FROM THE OWNERS. © POWERSEM LTD.

TITLE: B6U/H/C xx/xx PS352/390/180B

JOB:

MAT'L:

SPEC.

FINISH:

SCALE 1:4

DRAWN PB

CHK'D MP

MDD. No

ISSUE No

1/22.05.00

DRG.No.B 020300

ASSEMBLY DN:
 ASSEMBLY DN

THIRD ANGLE PROJECTION

