



RECTIFIERS
The Custom Power Specialist



Certificate No. 152

ISO 9001: 2000

Water Cooled Heatsinks 5

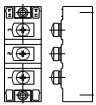
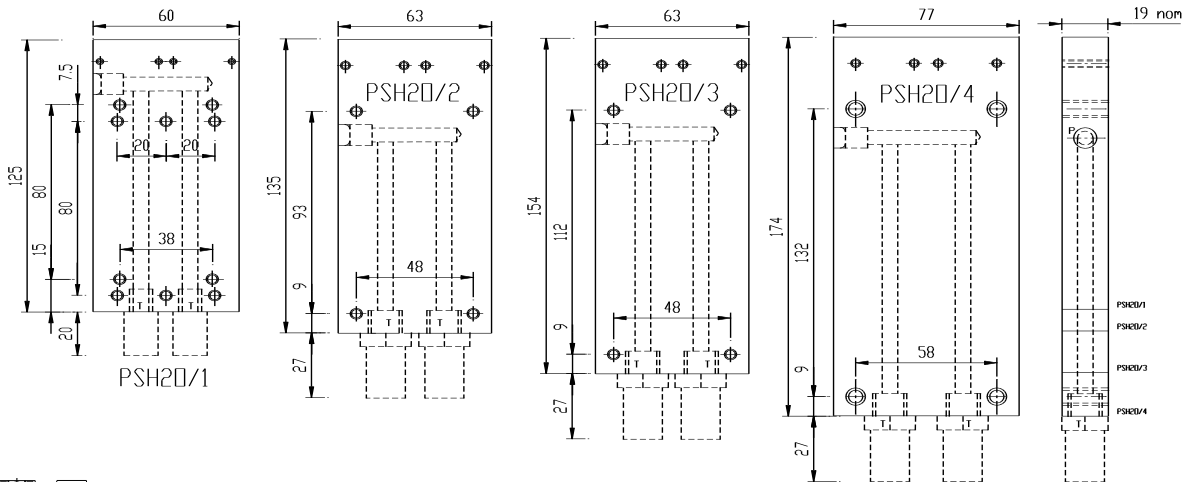

Thyristor. Thyristor / Diode. Diode / Diode. Mosfet & IGBT Isolated Modules.

PSH20/50

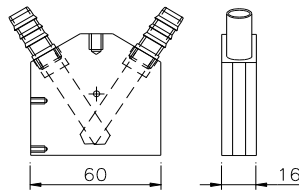

PSH20/50+BB

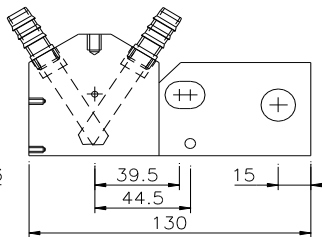

PSH20/80

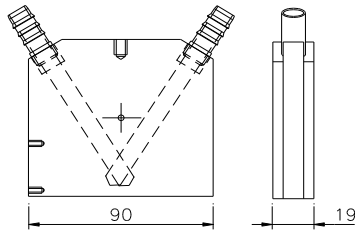

PSH20/80+BB

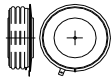
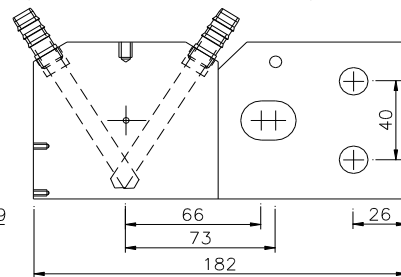

Thyristor. GTO. Diode. Mosfet & IGBT Capsule Devices.

Sink Ref.	Module	H2o	H2o PD	Rth C/W	Rth C/W	H2o	Hose Dia
	Ctrs / Device	L /min	mbar	SSC*	DSC*	Connector	
PSH20/1	3x80 & 80x38	4	190	0.042	-	1/8" BSPT	8 OD
PSH20/2	93x48	4	180	0.04	-	1/4" BSPT	10 OD
PSH20/3	112x48	5	180	0.038	-	1/4" BSPT	10 OD
PSH20/4	132x58	5	180	0.036	-	1/4" BSPT	10 OD
PSH20/50	<50mm Pole	5	160	-	0.02	SS Hose Barb	10 ID
PSH20/80	<80mm Pole	5	160	-	0.016	SS Hose Barb	10 ID

* Plated Copper. Large area heat source.

Thermal data for guideline only. Full data available on request.

GD Rectifiers Ltd. Bentley House, 2 William Way, Burgess Hill, West Sussex RH15 9AG.

Tel: 01444 243452 Fax: 01444 870722

E-Mail: enquiries@gdirectifiers.co.uk Web Site: www.gdirectifiers.co.uk